

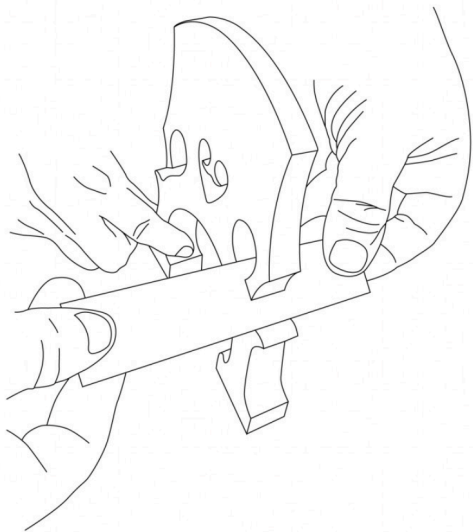

KNA PICKUPS

DB-1 DOUBLE BASS PICKUP
INSTALLATION GUIDE

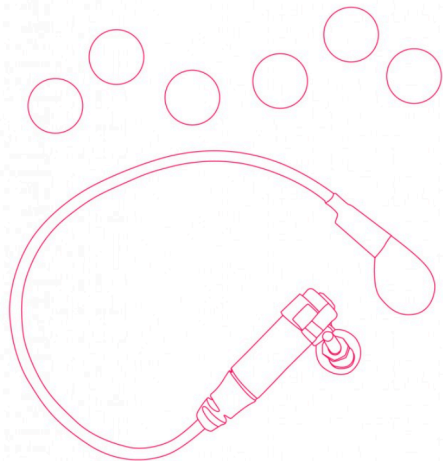

Remove the pickup and other materials from the box.

The BD-1 is designed to fit any double bass bridge. Some bridge slot openings will need to be widened slightly. We recommend 200 grit sandpaper, folding the paper appropriately to make it sturdy. If possible, use a thin piece of plastic or metal plate between the sandpaper. This will help while sanding and keep the sanded surface flat, which is important. Before you start sanding, use appropriately cut cardboard placed around the bridge to protect the varnish of the instrument. Widen the slot slowly, stopping frequently to try attaching the pickup sensor. This will avoid making the slot too wide.

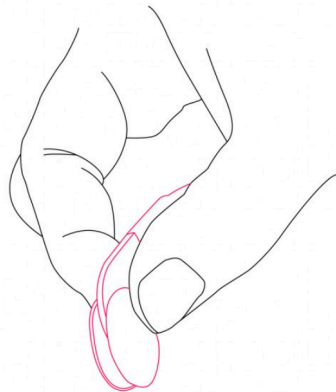
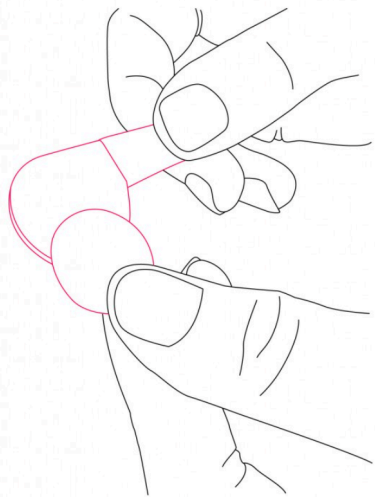

If the slot is wider than the sensor use the additional provided shims. Line up the necessary number of shims along with the sensor and slide them in the slot under the 1st (G) string. The sensor will operate equally well from either side of the bridge. We recommend installing the sensor on the right side of the bridge (G string side). Some players prefer to install the sensor on the left side (E string side).

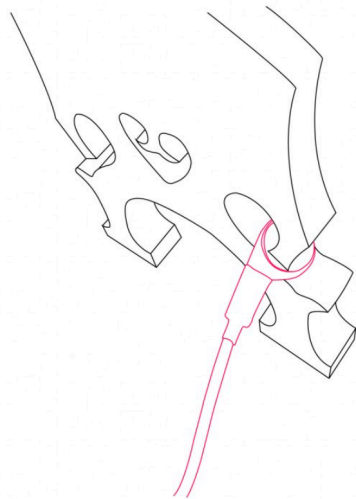
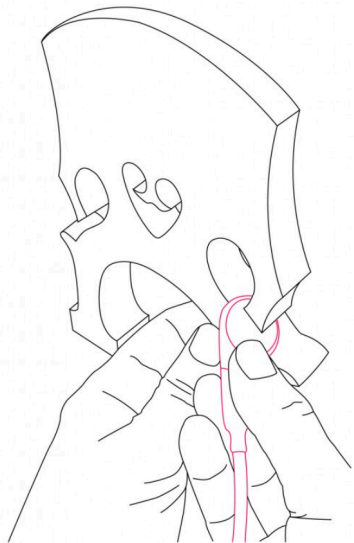

The sensor should be facing down with the flat side of the lead cable. Hold the bridge with one hand so it does not move while installing the sensor. The sensor should fit tightly but install without force. It should not move while playing or even shaking the double bass, but not too tight where the sensor or bridge can be damaged or broken.

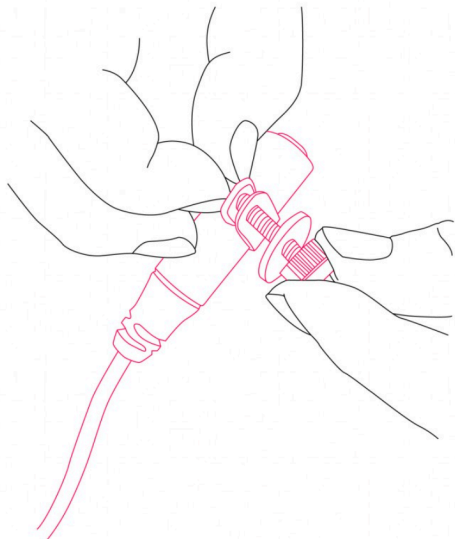
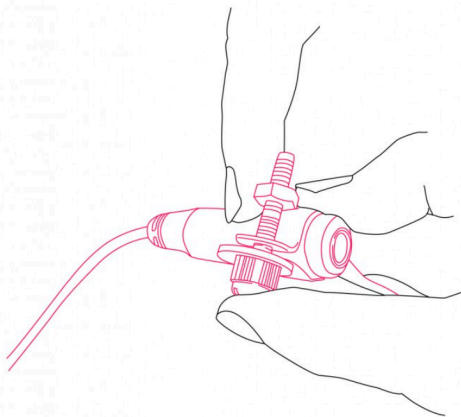

To attach the jack clip to the tailpieces, unscrew the nut and washer to completely open the retaining bracket with the clamp. Remove the washer.

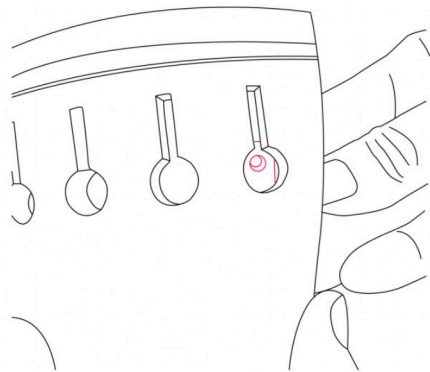
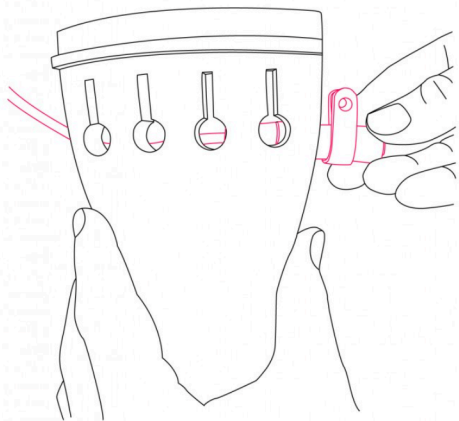

Position the retaining bracket beneath the tailpiece near the G string slot. We recommend installing the jack housing on the right side of the tailpiece (G string side).

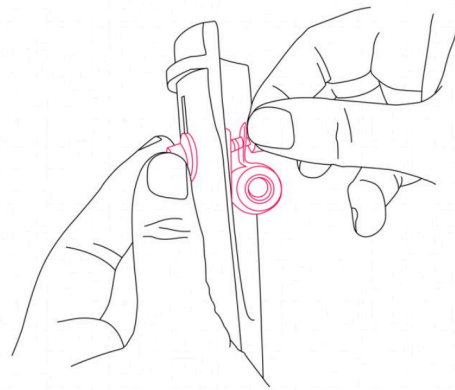
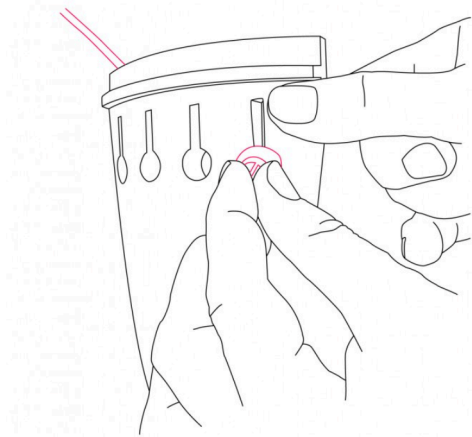

Feed the screw through this slot and the washer. Tighten the washer screw, holding the nut with the fingers of your other hand.

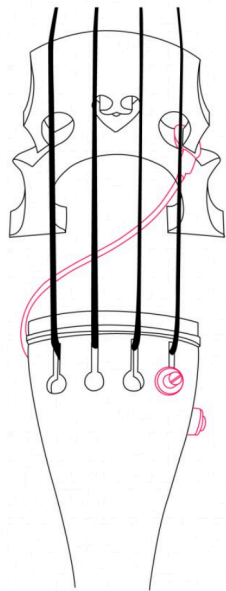
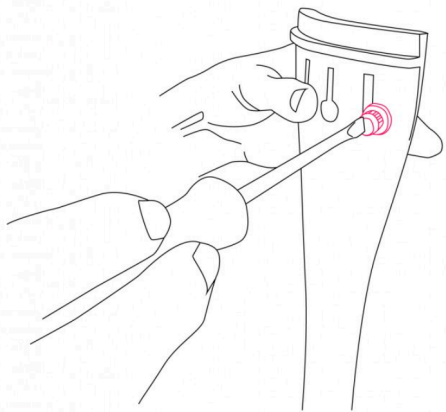

You can use a slotted screwdriver to tighten additionally if needed. Do not overtighten to avoid damaging the screw thread or tailpiece. Always hold the jack housing with one hand while plugging and unplugging the cable.

With the volume of your amplifier set to zero, plug a high-quality instrument cable into your pickup and into your favorite direct box, preamp or acoustic amplifier.

You are now ready to enjoy your new pickup!